



Maple Gardens | | Yateley | GU46 6JQ

£415,000

Freehold

*Waterfords* W  
Residential Sales & Lettings

Maple Gardens |  
Yateley | GU46 6JQ  
£415,000

A three-bedroom semi-detached home with a refitted kitchen/dining room, updated bathroom, and garage. Offered to the market with no onward chain!

- Three Bedrooms
- Modern Kitchen/Dining room
- Close to Local Amenities
- Garage in block
- Semi-Detached
- Private Rear Garden
- No onward chain
- Gas central Heating





## Description

A short stroll from Yateley Common Country Park and close to local amenities and well-regarded schools, this well-presented three-bedroom semi-detached home is offered with no onward chain. The property features a refitted kitchen/dining room with built-in oven and hob overlooking the rear garden, a front-aspect living room, and three bedrooms served by a modern family bathroom. Outside, there is a front lawn and a rear garden mainly laid to patio with a large storage shed. Further benefits include double glazing, gas central heating, and a garage in a nearby block.



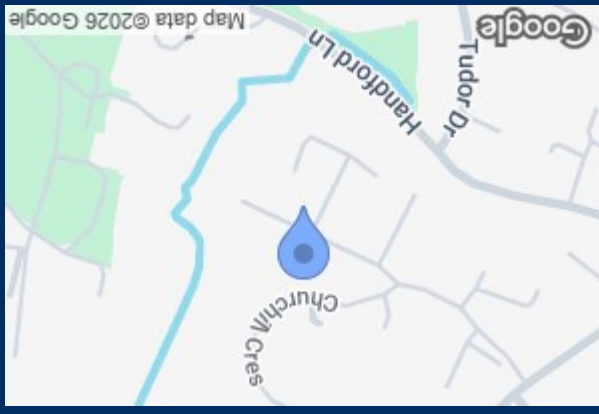

Energy Efficiency Rating	
Current	Potential
82	63

England & Wales	
EU Directive 2002/91/EC	
A	Very energy efficient - lower running costs
B	(81-91)
C	(69-80)
D	(55-68)
E	(39-54)
F	(21-38)
G	(1-20)
Not energy efficient - higher running costs	

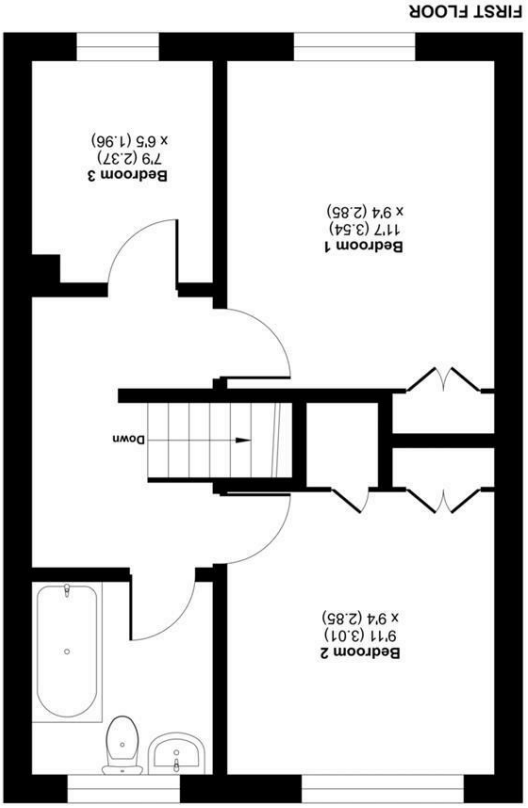
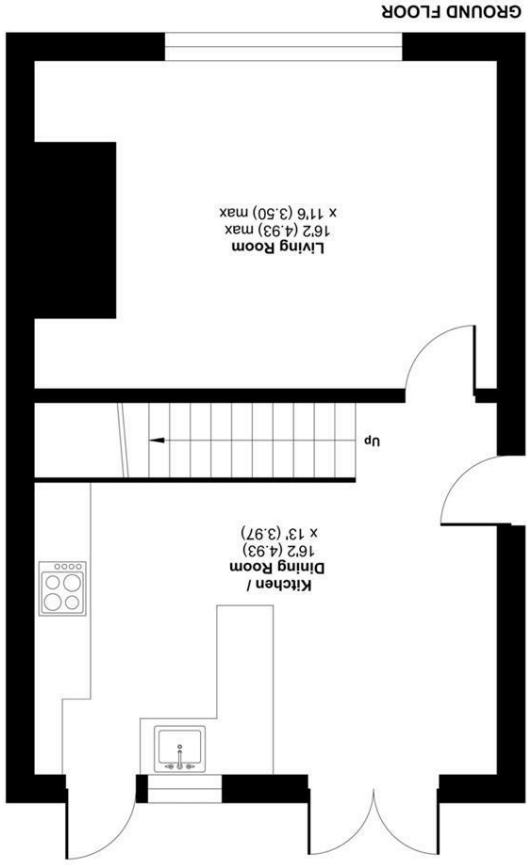

Floor plan produced in accordance with RICS Property Measurement Standards (IPMS2 Residential), incorporating International Property Measurement Standards (IPMS2 Residential). © n3hocom 2026. Produced for Waterfords. REF: 1454512  

 Waterfords Residential Sales & Lettings

**Maple Gardens, Yateley, GU46**  
 Approximate Area = 808 sq ft / 75 sq m  
 For identification only - Not to scale

35 Plough Road  
 Yateley  
 Hampshire  
 GU46 7UW  
 01252 870222  
 yateley@waterfords.co.uk